



Venue information

STATE
LIBRARY
OF NSW

Venue information



STATE LIBRARY®
NEW SOUTH WALES



Acknowledgment of Country

The State Library of NSW offers our respect to Aboriginal Elders past and present, and extends that respect to other First Nations people. We celebrate the strength and diversity of NSW Aboriginal cultures, languages and stories.

The State Library of NSW is home to a variety of spectacular venue hire spaces available for your next event.

Located in the heart of Sydney's CBD, the State Library has venues to accommodate a diverse range of events, from small meetings to large workshops, presentations, cocktail parties, film screenings, hybrid events, weddings and more.

Contact

Venue Hire, Visitor Services Branch
State Library of NSW
1 Shakespeare Place, Sydney NSW 2000
(02) 9273 1744
venue.hire@sl.nsw.gov.au
sl.nsw.gov.au

The Mitchell building is the home of the iconic Mitchell Library Reading Room and Mitchell Vestibule; it houses the Library Auditorium, Glasshouse, the Friends, Gallery, Dixon and Shakespeare Rooms, along with our exciting permanent and featured exhibition galleries.

The Macquarie St building includes our Metcalfe Auditorium, Macquarie Room, Cafe Trim and Macquarie foyer, renowned for hosting popular author talks, scholarly events and corporate functions.

Venue	Price
Library Auditorium inc. Glasshouse	\$4500
Glasshouse*	\$4000
Dixon Room	\$2400
Shakespeare Room	\$1000
Friends Room*	\$2990
Gallery Room	\$3150
Metcalfe Auditorium	\$2100
Macquarie Room	\$1100
Paintings Galleries*	\$4995
Mitchell Vestibule*	\$4500
Macquarie Foyer*	\$2650
Library Bar*	\$4000

Security fees will apply outside the Library's opening hours

* conditions apply



Library Auditorium

\$4500

Capacity

tiered theatre seating 344

Includes*

- 2 green rooms
- 10 m x 4 m screen
- 4K RGB laser cinema projector
- CinemaScope capability
- surround sound
- lectern with microphone
- 2 wireless microphones
- Access to the Glasshouse for catering, registration and display

** Please note that an audiovisual technician is required to access some advanced services \$POA.*



Glasshouse*

\$4000

A large, light filled atrium adjoining the Library Auditorium.

Capacity

cocktail 350

dinner round 210

Includes

trestle tables

high bar tables

conference chairs

** conditions apply*





Dixson Room

\$2400

Capacity

cocktail	200
theatre	150
dinner round	120
cabaret	80
classroom	78
clusters	56
long dining	54
u-shape	51
boardroom	42

Includes

- tables (trestle or dining)
- conference chairs
- stage
- data projector & screen
- laptop
- sound system
- lectern & microphone

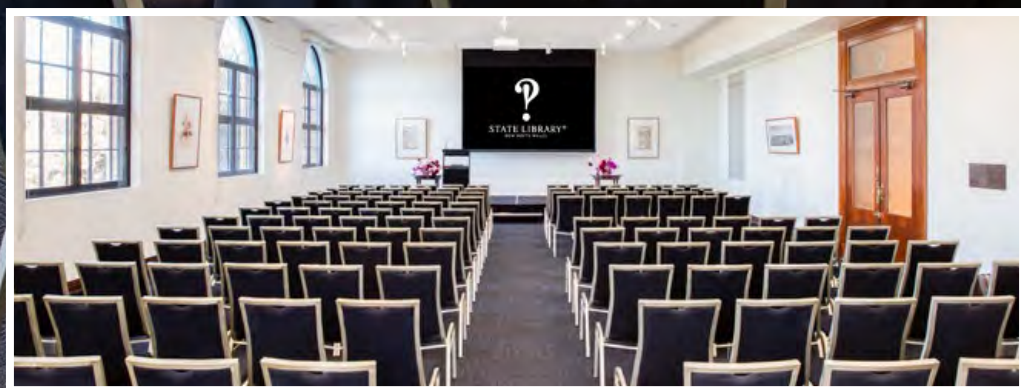



Shakespeare Room

\$1000

Capacity

cocktail	15
theatre	15
boardroom	10
dinner round	10
cabaret	8

Includes

tables (trestle or dining)
conference chairs



Friends Room*

\$2990

Capacity

cocktail	150
theatre	120
dinner round	70
cabaret	56
long dining	54

Includes

- tables (trestle or dining)
- lounge chairs
- conference chairs
- sound system

* conditions apply





Gallery Room

\$3150

Capacity

cocktail	200
theatre	150
dinner round	120
cabaret	80
clusters	80
long dining	60

Includes

- tables (trestle or dining)
- conference chairs
- LED screen
- laptop
- stage
- lectern & microphone



Metcalfe Auditorium

\$2100

Capacity

tiered auditorium
seating 132

Includes

tiered auditorium seating
data projector & screen
computer
lectern & microphone



Macquarie Room

\$1100

Capacity

cocktail	100
theatre	60
clusters	40
classroom	36
boardroom	36
u-shape	30

Includes

trestle tables
conference chairs
2 x LED 75" Screens
laptop





Galleries

Paintings from the Collection

\$4995

More than 300 original artworks from the Library's unique collection of landscape and portrait paintings on permanent public display.

Paintings Galleries*

cocktail	350
----------	-----

** conditions apply*

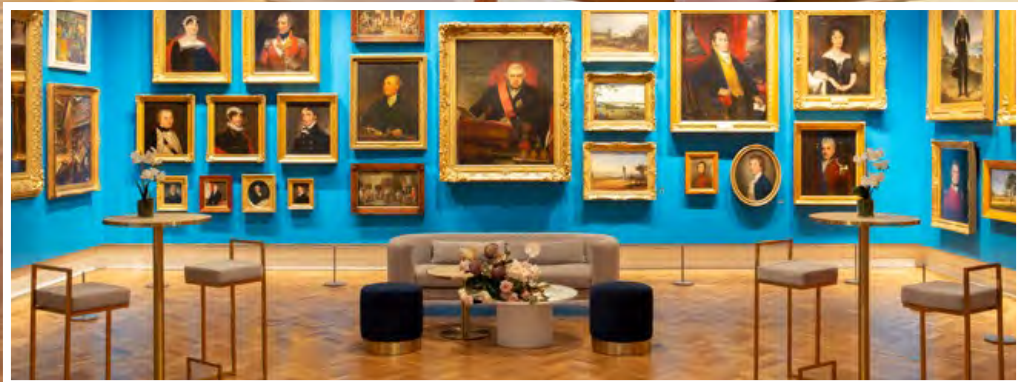



Exhibition Galleries and Public Spaces

The Library's exhibition galleries and public spaces are available for hire outside of Library opening hours, subject to approval from the State Library of NSW.

For more information about our exhibition galleries and the use of public spaces, please contact our Venue Hire team directly via venue.hire@sl.nsw.gov.au or (02) 9273 1744.

Mitchell Vestibule*	\$4500
cocktail	150
dinner	70

** conditions apply*

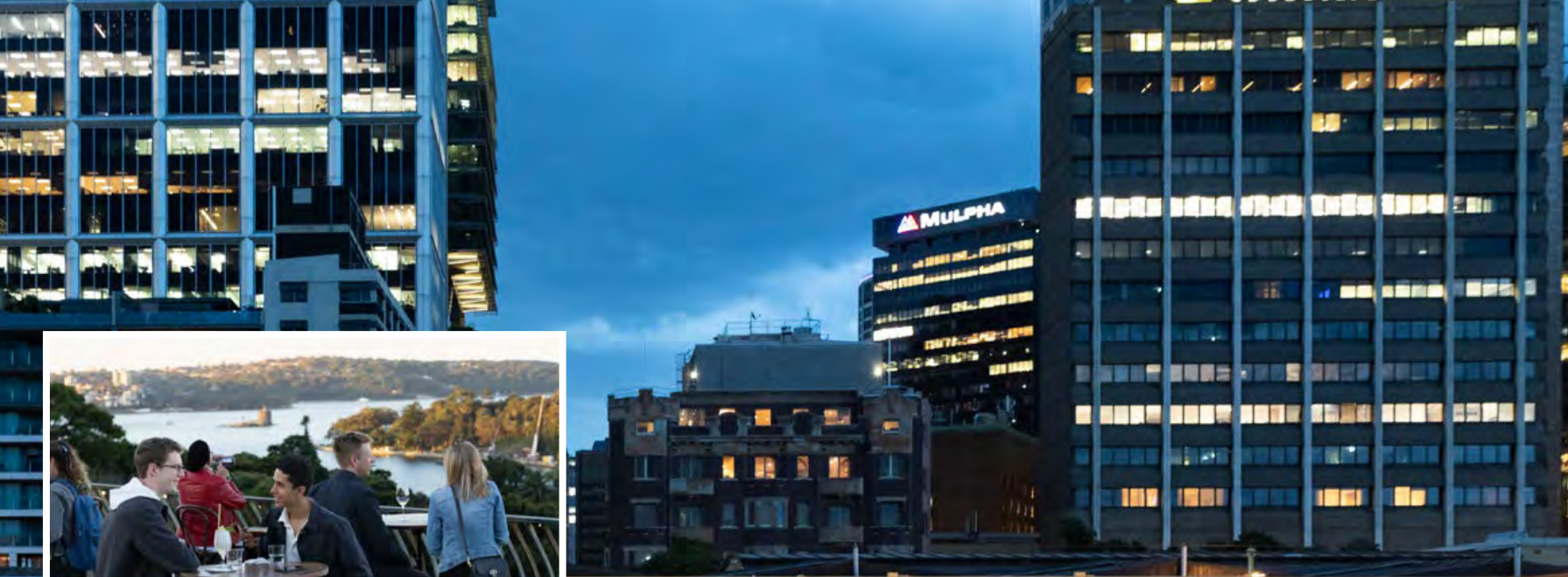

Library Bar*

\$4000

The Library Bar is located on the rooftop of the historic Mitchell Building, includes indoor and outdoor space and features unique views across to the Harbour and city skyline.

The Library Bar is available for private hire outside of bar opening hours.

Capacity

licensed for 120

Includes

- bar furniture
- microphone
- sound system

** conditions apply*



Catering

Laissez-Faire Catering pride themselves on providing an extraordinary experience through the quality of their cuisine, legendary service and attention to every detail.

With over 30 years catering experience, both in-house and offsite, they produce and deliver high-end, large and boutique scale events. They source fresh, local seasonal produce, create innovative menus, provide you with superior service and full-time event catering support.

Please contact Laissez-Faire Catering directly and their friendly staff will assist you in arranging all your catering needs.



Laissez-Faire Catering

30 Birmingham Street
Alexandria NSW 2015
(02) 9209 4810
admin@laissez.com.au
www.laissez.com.au



State Library of NSW

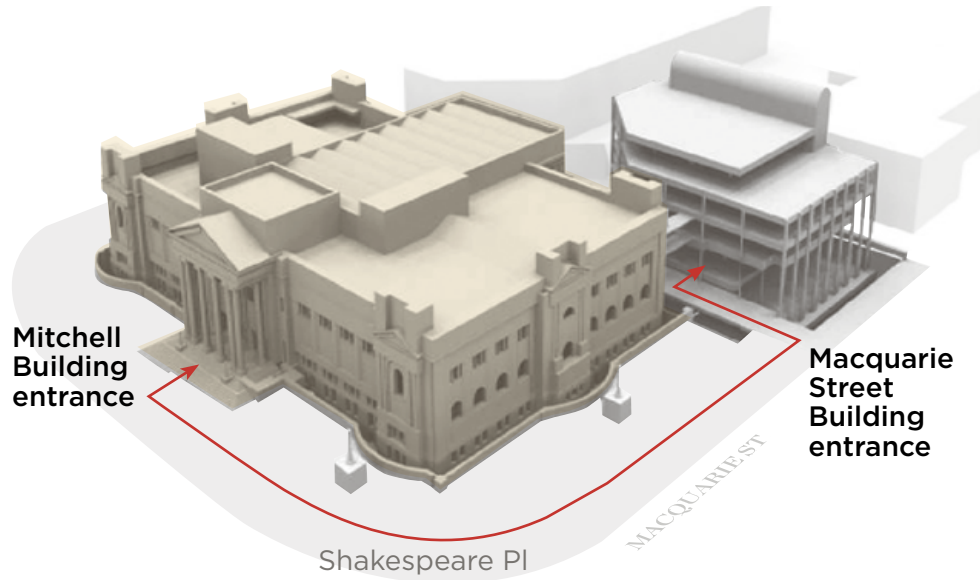

Venues

F Library Auditorium	D Paintings Galleries
E Glasshouse	C Amaze Gallery
A Mitchell Vestibule	A Galleries
H Dixson Room	G Access to the Library Bar
I Shakespeare Room	M Metcalfe Auditorium
K Friends Room	N Macquarie Room
L Gallery Room	

Level 1

- A Galleries
- B Map Rooms
- C Amaze Gallery
- D Paintings Gallery
- E Drawings, Watercolours & Prints Gallery
- F Glass bridge between buildings
- G Circulation Gallery

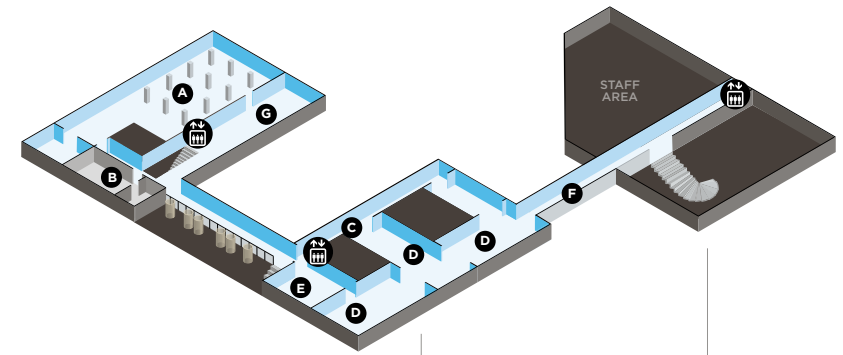

Ground level

MITCHELL BUILDING

- A Mitchell Vestibule
- B Mitchell Library Reading Room
- C Special collections
- D Family Room
- E John B Fairfax Learning Centre
- F Objects Gallery
- G Library Bar (lift to rooftop)
- H Dixson Room
- I Shakespeare Room
- J Ginibi Room
- K Friends Room
- L Gallery Room

MACQUARIE ST BUILDING

- M Metcalfe Auditorium
- N Macquarie Room
- O Cafe
- P Library Shop

* Accessible entry points

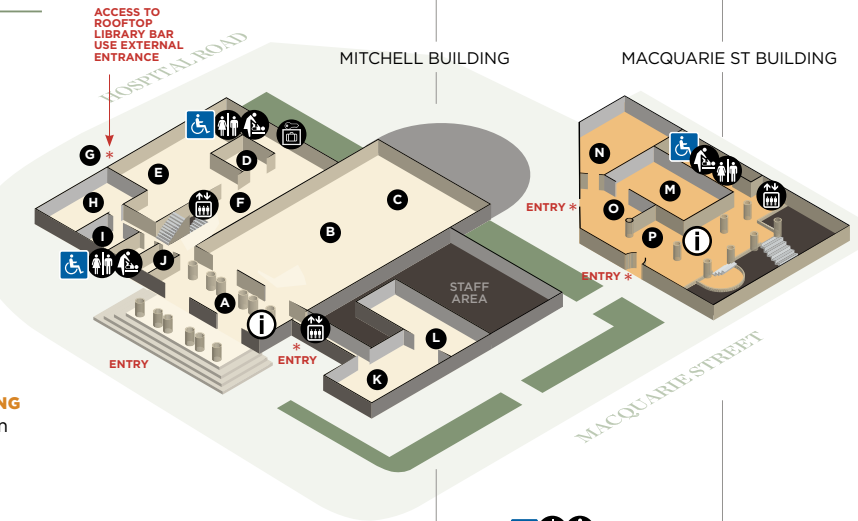

Lower Ground 1

- A Gov. Marie Bashir Reading Room
- B Dalangilla ngurra study room
- C Flinders Room
- D Children's Library
- E Glasshouse
- F Library Auditorium
- G Photography Gallery

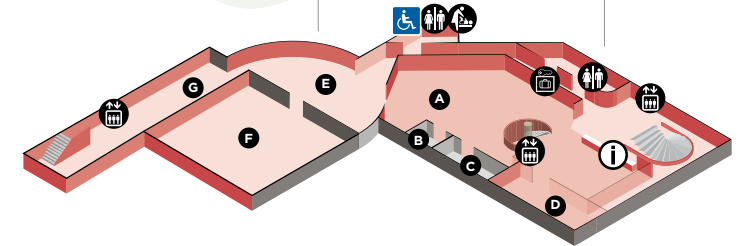

Lower Ground 2

- A Gov. Marie Bashir Reading Room
- B Special materials
- C Family History
- D Study rooms 1-4

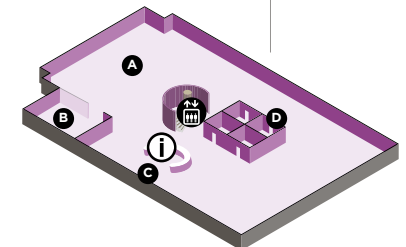



Contact

Venue Hire, Visitor Services Branch
State Library of NSW
1 Shakespeare Place, Sydney NSW 2000
(02) 9273 1744
venue.hire@sl.nsw.gov.au
sl.nsw.gov.au